



AVK SUPA LOCK™ TAPPING SADDLE, PN 16

100/14-003

For cast iron, ductile iron and steel pipes, with Supa Lock™ socket outlet

AVK Supa Lock™ is a patented service connection system consisting of tapping saddles, valves and fittings with a fast two-step assembly without threads or use of tools. Supa Lock™ features a corrosion protected push-in and quick-lock joint secured by a safety retainer which prevents demounting under pressure. The tapping saddles are designed with Supa Lock™ socket outlet and a large profiled rubber gasket to ensure a drop tight seal against the pipe. The nuts are located in a recess to ease installation and prevent them from rotating when tightening the bolts.

Product description:

Supa Lock™ tapping saddle for cast iron / ductile iron / steel pipes for water and neutral liquids to max. 70° C

Features:

- Fully coated with epoxy according to DIN 30677-2, GSK approved
- Supa Lock™ joint: Easy two-step assembly by pushing the Supa Lock™ spigot end into the Supa Lock™ socket end, and clicking on the safety retainer, which is fitted on the spigot end of the valves and fittings. The safety retainer is easy to mount and demount, and as extra safety the patented Supa Lock™ joint prevents demounting when the system is under pressure. The joint is sealed by two large O-rings of drinking water approved EPDM rubber. The O-rings are placed on the spigot ends of the valves and fittings.
- The Supa Lock™ outlet is designed with rotation stop to prevent rotation during the tapping/drilling process
- Ø32 bore for standard drill bit sizes
- The saddle is sealed against the pipe by a gasket of drinking water approved EPDM rubber
- A SBR rubber lining covers the internal surface to protect the pipe surface
- Bolts of stainless steel A2 and fully epoxy coated bolt holes to protect against corrosion
- Nuts of acid-resistant stainless steel A4 with antifriction coated surface, located in a recess in the lower part

Accessories:

Supa Lock™ valves and fittings



Expect... **AVK**

AVK SUPA LOCK™ TAPPING SADDLE, PN 16

100/14-003

For cast iron, ductile iron and steel pipes, with Supa Lock™ socket outlet

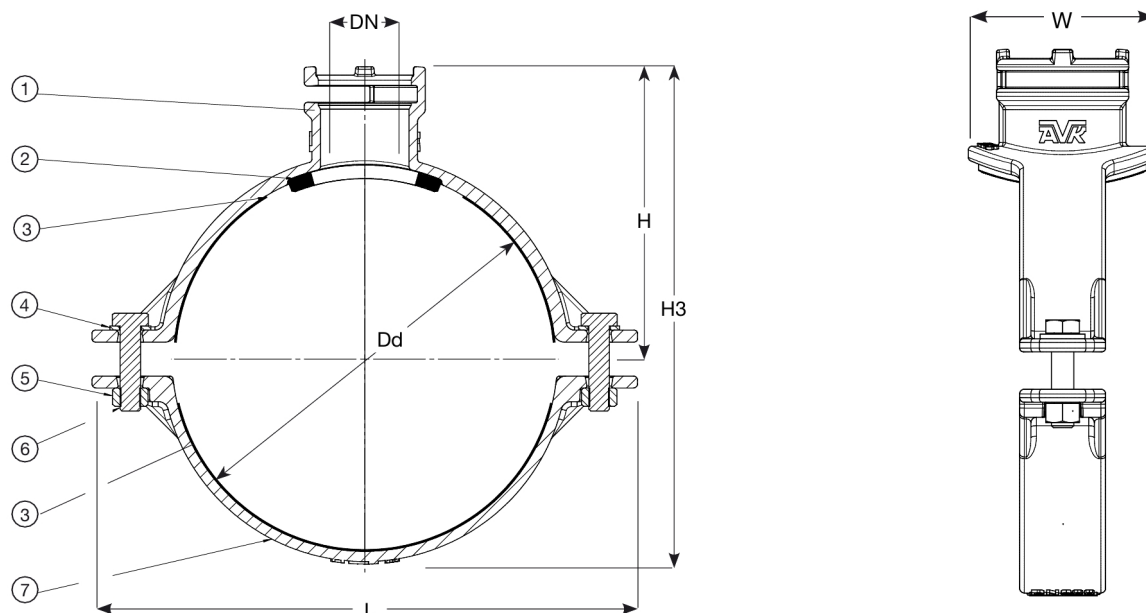

Component list:

1. Upper part	Ductile iron GJS-500-7 (GGG-50)	5. Nut	Stainless steel A4
2. Gasket	EPDM rubber	6. Bolt	Stainless steel A2
3. Liner	SBR rubber	7. Lower part	Ductile iron GJS-500-7 (GGG-50)
4. Washer	Stainless steel A2		

Components may be substituted with equivalent or higher class materials without prior notification.

Reference nos. and dimensions:

AVK ref. no.	DN mm	Tolerance mm	H3 mm	H mm	L mm	W mm	Theoretical weight / kg
100-067-14-320464	32	60 - 67	132	90	187	101	1.7
100-083-14-320464	32	76 - 83	150	100	187	101	1.6
100-099-14-320464	32	88 - 99	165	107	187	101	1.6
100-119-14-320464	32	114 - 119	185	117	216	101	1.8
100-171-14-320464	32	168 - 171	239	145	268	101	2.2
100-223-14-320464	32	219 - 223	292	172	320	101	2.6